

Kitchen

COLLECTION

2023 Brochure





We specialise in quality kitchens and bedrooms for less.
All our furniture is easy to like, easy to buy and easy to fit and once you have one we know you will love it!

Our cabinets are of traditional 'glue and dowel' construction and are produced using the latest computer controlled machinery throughout the manufacturing process. We are so confident in our product, that it comes with a reassuring 10 year guarantee on all of our cabinets.

Please see a summary of our guarantee of individual items listed below.

10 years – Cabinet, drawer boxes, door hinge & drawer runners

5 years – Doors, drawer fronts, internal storage solutions and handles

1 year – Other accessories



We reserve the right to change products at any time.

Please note: Due to photographic and printing processes, the colours shown here may not be a true representation of the product. Please see samples for the actual colours.

There are many reasons to choose one of our kitchens.

Our kitchens are simple to buy and easy to fit. Take a closer look and you'll find many more reasons to choose a kitchen from us over any other.

...here are just a few of them.

1 20 cabinet finishes
We have 20 cabinet finishes that match or complement the majority of our door finishes. They look as good on the inside as they do on the outside, which is the sign of a quality manufacturer and they minimise costly finishing panels.

2 Glue & dowel construction
A rigid cabinet is a must in a top quality kitchen. Our cabinets are made using glue and dowel construction and each one is made to order meaning only the holes that are required are drilled.

3 Internal Accessories
We use the highest quality internal accessories from Kesseböhmer. These include corner Cantilever and Pull-Out access solutions, along with Base, Wall and Tall pull-outs for easy accessible storage.

4 High quality drawers
We offer a choice of drawers in either steel or wood. Both with soft closing full extension runners with capacity to hold up to 65kg.

5 Unit availability
We offer one of the widest range of unit widths in the market, ensuring maximum storage utilisation and therefore avoiding the need for unnecessary filler panels.

6 Range of lighting
We offer a wide range of lighting from mood, task and convenience to add that finishing touch to your kitchen.

7 Complementary worktops
With 40 traditional and contemporary finishes, ranging from a slim 16mm square edged worktop through to 38mm radiused style, you are guaranteed to find the perfect match for your dream kitchen.

8 All cabinets are made to order & hand built in the UK.

To help you choose, please use our simple style guide.



Profile Pages 6 to 18

A Profile kitchen creates a true handleless look by using a profile rail to allow easy door opening. The profile rail is available in nine complementary finishes.



Slab Pages 20 to 43

Slab kitchens are perfect for those seeking a minimalist feel. These doors can be used with an extensive range of attractive handles allowing you to create an individual look.

Please see our extensive range of handles on pages 100 and 101.



Shaker Pages 44 to 71

The Shaker kitchen design is a true classic suitable for a broad range of homes. There is a wide range of choice from traditional through to modern shaker style kitchens.

Please see our extensive range of handles on pages 100 and 101.



Handleless Pages 72 to 79

Handleless kitchen doors are perfect for the stylish modern kitchen with an integrated 'J' pull grip to create a visually handleless look and feel.

Profile Kitchens

A true handleless Kitchen

Over the next few pages you will see our collection of Profile kitchens that create a truly handleless look using a profile available in 9 complementary finishes.

Pages 8 to 17.

Choice of profile finishes



Aluminium Brushed



White Matt Painted



Black Brushed

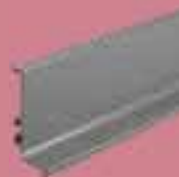

Dust Grey Painted



Graphite Painted



Grey Brushed



Bronze Brushed



Brass Brushed



Copper Brushed







Profile

in Profile Indigo Blue Soft Matt Slab
Soft Matt Slab

Create an impressive uber contemporary kitchen by combining our Indigo Blue Soft Matt with a contrasting plain soft matt colour.

Shown with:

Aluminium Brushed Profile Handleless Trim
Top Boxes
Tall Oven Housing & Larder Units (2115 High)
Feature Island
Matching Plinth

All Profile door finishes are shown on page 18

The profile rail is available in a choice of 9 contemporary finishes



Profile Natural Walnut Slab & Profile Dust Grey Slab

Matt MFC Slab & Matt Foil Slab . Shown with Dust Grey Painted Profile Handleless Trim

Profile

in Profile Light Grey Gloss Slab &
Profile Anthracite Gloss Slab
Painted Gloss Slab

Complement the gloss slab doors with an aluminium profile trim to create a sleek stylish look. The use of anthracite gloss doors creates a dramatic focal point at the heart of the kitchen.

Shown with:

Aluminium Brushed Profile Handleless Trim
Hi-Line and Two Drawer Base Unit
Wall Units (720 High)
Tall Oven Housing & Larder Units (2115 High)
Hi-Line Base Units with Hi-Line Feature End Panels
Matching Plinth

All Profile door finishes are shown on page 18

The profile rail is available in a choice of
9 contemporary finishes









Profile

in Profile White Gloss Slab &
Profile Milano Concrete Slab

Painted Gloss Slab & Designer Matt MFC Slab

The concrete finish island used with the ever popular gloss white door, presents an exciting combination of textures. The whole effect is enhanced by the addition of a copper profile trim creating a contemporary striking design.

Shown with:

Copper Brushed Profile Handleless Trim

Two Drawer Base Units with Drawerline
Feature End Panels

Tall Oven Housing & Larder Units (2115 High)

Hi-Line Base Units with Hi-Line
Feature End Panels

Matching Plinth

All Profile door finishes are shown on page 18

The profile rail is available in a choice of 9
contemporary finishes

Profile

in Profile White Matt Slab, Denim Blue Matt Slab & Smoke Blue Matt Slab
Painted Matt Slab & Designer Matt MFC Slab

There's no need to stick to one colour in the kitchen, a combination of different shades and textures can create an individual look and feel in your home, as shown in this image.

Shown with:

Aluminium Brushed Profile Handleless Trim
Two Drawer Base Units with Drawerline Feature End Panels
Tall Oven Housing & Larder Units (2115 High)
Hi-Line Island Base Units with Hi-Line Feature End Panels
Matching Plinth

All Profile door finishes are shown on page 18

The profile rail is available in a choice of 9 contemporary finishes





Profile

in Profile Jupiter Slab &
Profile Fjord Green Matt Slab
Designer Matt MFC Slab

Combine a solid matt door and a textured slab door with a black brushed profile trim to create a sophisticated look and feel.

Shown with:

Black Brushed Profile Handleless Trim
Two & Three Drawer Base Units
Tall Oven Housing & Larder Units (2115 High)
Hi-Line Island Base Units with Hi-Line
Feature End Panels
Matching Plinth
Bronze Glazed Wall Units with Brown Frame
Reference [CG](#) see page 18

All Profile door finishes are shown on page 18

The profile rail is available in a choice of 9 contemporary finishes





Select your Profile door finish

Choosing your door style and finish is important. Colour match to your desired kitchen finish or choose a contrast to suit your personality.

GLAZED CONTEMPORARY GLASS

with the following symbol have a glazed door option.

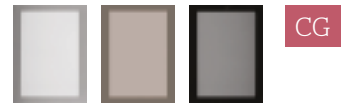

Clear Bronze Smoked

Profile PRICE GROUP 1 Matt MFC Slab

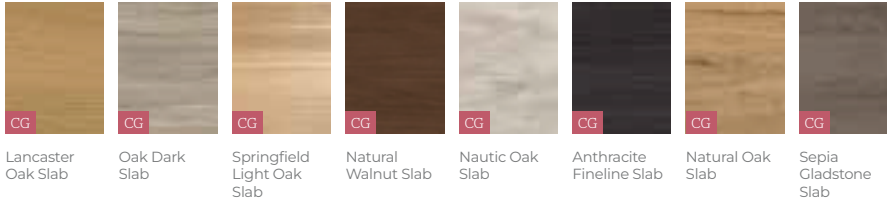

Profile PRICE GROUP 1 Matt Foil Slab

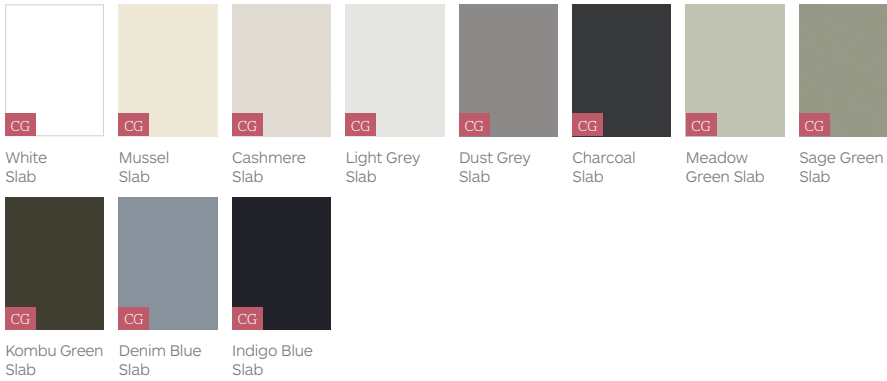

Profile PRICE GROUP 2 Painted Matt Slab

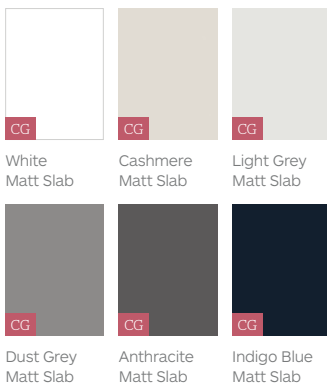

Profile PRICE GROUP 2 Painted Gloss Slab

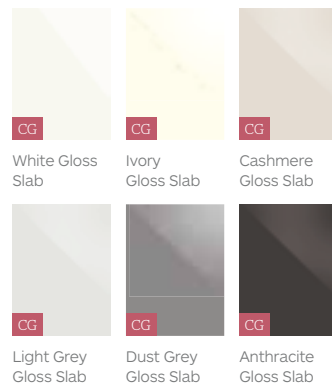

Profile PRICE GROUP 2 Soft Matt Slab (Laminate Foil)

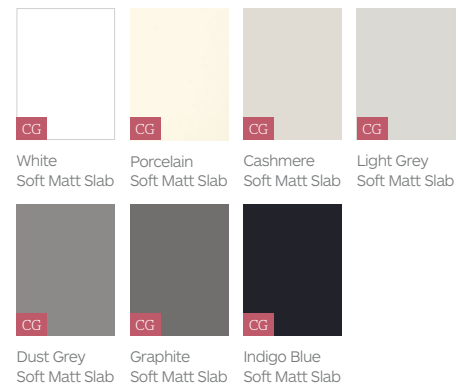

Profile PRICE GROUP 3 Designer Matt MFC Slab



Slab, Shaker & Handleless Kitchens

Over these pages we want to show some of our favourite kitchens that have either a handle fitted or an incorporated 'J' pull handle to give a handleless look.

You can find our collection of handles on pages 90 & 91





Slab

in Oak Dark Slab & Cashmere Slab
Matt MFC Slab & Matt Foil Slab

This stylish kitchen showcases a contemporary look, merging the natural warmth of oak with the softness of cashmere tones.

Shown with:

Tall Oven Housing & Larder Units (2115 High)
Open Display Wall Unit shown as End Unit
Matching Plinth
Brushed Steel Slimline Handle Set
(TH1001, TH1002, TH1003)



Cashmere Slab & Kombu Green Slab

Matt Foil Slab . Shown with Stainless Steel 'D' Scalloped Handle Set (TH303 & TH304)

Slab

in White Slab & Natural Walnut Slab
Matt Foil Slab & Matt MFC Slab

The kitchen exhibits a clean and inviting atmosphere, balancing the crispness of White with the timeless beauty of Natural Walnut.

Shown with:

Mid Height Oven Housing & Larder Units
(1400 High)

Splayed Diagonal Wall Units

Stainless Steel 'D' Scalloped Handle Set
(TH303, TH304)





Slab

in Cashmere Slab
Matt Foil Slab

This Cashmere Slab kitchen pairs seamlessly with Springfield Light Oak cabinet, creating a harmonious blend of soft elegance and warm, natural tones.

Shown with:

Brushed Aluminium Wrap Over Handle Set
(TH326, TH327, TH328)

Wrap Over Handles are available in Aluminium Brushed, Chrome, Graphite, Bronze, Copper & Black.



White Slab

Matt Foil Slab. Shown with Brushed Steel Block Bar Handle Set (TH351 & TH354)







Slab

in Cashmere Matt Slab
Painted Matt Slab

A distinctive kitchen in a matt painted finish that allows anyone to personalise their kitchen and make it their own.

Shown with:

Two Drawer Base Units

Tall Oven Housing & Larder Units (2115 High) clad in 18mm matching panelling

Matching Plinth & Panelling

Satin Nickel Bow Handle Set (TH307)

Slab

in White Matt Slab
Painted Matt Slab

A matt painted finish featuring contemporary glazed units. Matching backsplash and worktop complement the look.

Shown with:

Breakfast Bar Island with Hi-Line Base Units
Mid Height Oven Housing & Larder Units
(1590 High)
Matching Plinth & Panelling
Chrome 9mm Square Bar Handle (TH1128)
Clear Glazed Wall Units with Silver Frame
Reference [CG](#) see page 85







Slab

in Dust Grey Matt Slab
Painted Matt Slab

These sleek and contemporary kitchens finished in matt or gloss painted Dust Grey create the perfect modern look.

Shown with:

Short Wall Units (290 High) clad in 18mm matching panelling

Mid Height Oven Housings & Larder Units (1590 High)
Matching Plinth & Panelling

Brushed Steel Block Bar Handle Set (TH351 & TH354)



Dust Grey Gloss Slab

Painted Gloss Slab. Shown with Brushed Steel Block Bar Handle Set (TH351 & TH354)

Slab

in Light Grey Gloss Slab
Painted Gloss Slab

These painted gloss doors create a contemporary look with clean lines that are fresh in design and provide a perfect canvas for a feature handle of your choice.

Shown with:

Vertical Bi-Fold Wall Units (720 High)

Hi-Line Base Units

Feature Island with Two Drawer Base Units
& Breakfast Bar

Matching Plinth

Chrome 9mm Square Bar Handle (TH1128)









Slab

in Dust Grey Soft Matt Slab
Soft Matt Slab (Laminate Foil)

This soft matt door in a robust and easy to care for finish creates a smooth clean design giving this kitchen a contemporary feel.

Shown with:

Hi-Line & Three Drawer Base Units
Wall Units (575 high) clad in 18mm
matching panelling
Matching Plinth & Panelling
Grey 9mm Square Bar Handle (TH1126)

Slab

in Porcelain Soft Matt Slab
Soft Matt Slab (Laminate Foil)

This kitchen exudes a subtle and refined aesthetic, offering a smooth and muted texture that enhances the overall sophistication of any space.

Shown with:

Wall Units (720 High)
Three Drawer Base Units
Matching Plinth
Graphite Angular 'D' Handle Set (TH1157 & TH1158)



Home office workspace in matching front.







Slab

in Milano Concrete Slab &
Milano Oxide Slab
Designer Matt MFC Slab

The slab door in these two Milano finishes creates a modern urban feel in any kitchen. Perfect for the contemporary home.

Shown with:

Two Drawer Base Units
Vertical Bi-Fold Wall Units (720 High)
Tall Larder Units
Matching Plinth & Panelling
Bronze Wrap Over Handle Set
(TH1094, TH1095, TH1096)

Wrap Over Handles are available in Aluminium
Brushed, Chrome, Graphite, Bronze, Copper & Black.

Slab

in Fjord Green Matt Slab & Jupiter Slab
Designer Matt MFC Slab

The combination of a solid matt slab door and a textured slab door creates a clean, complementary design. Making it ideal for the modern homemaker.

Shown with:

Vertical Bi-Fold Wall Units (720 High)
Tall Oven Housing & Larder Unit (2300 High)
Matching Plinth & Panelling
Brushed Copper 9mm Square Bar Handle (TH1063)



Jupiter Slab Feature Island, Designer Matt MFC Slab





Slab

in Denim Blue Matt Slab &
Smoke Blue Matt Slab
Designer Matt MFC Slab

Using two subtle blue finishes creates a contemporary look which makes this kitchen the ideal sociable, living space.

Shown with:

Two Drawer Base Units
Hi-Line Base Units
Tall Oven Housing & Larder Units (2115 High)
Matching Plinth & Panelling
Black Wrap Over Handle Set
(TH1078, TH1079, TH1080)

Wrap Over Handles are available in Aluminium
Brushed, Chrome, Graphite, Bronze, Copper & Black.





Shaker

in White Slim Shaker &
Kombu Green Slim Shaker
Matt Foil Slim Shaker

Create a striking effect in any kitchen by mixing a bold colour with a complementary contrasting finish that truly shows character and flair.

Shown with:

Drawerline and Hi-Line Base Units
Modern Cornice & Light Pelmet
Matching Plinth & Panelling
Antique Bronze Knob & Shell Handle
(TH1041, TH1040)









Shaker

in Shaker Woodgrain Cashmere
Five Piece Foil Woodgrain Shaker

This timeless shaker design in a classic finish with a wide frame in a woodgrain texture creates depth and character.

Shown with:

Five Drawer Base Units with Radius Pilasters
Feature Mantle

Feature Island with Radius Pilasters

Traditional Cornice & Light Pelmet

Matching Plinth & Panelling

Antique Pewter Handle (TH138)

Glazed Dresser Units Reference [CL](#) see page 85

Shaker

in Shaker Woodgrain Light Grey
Five Piece Foil Woodgrain Shaker

An attractive shaker design in a woodgrain finish features matching worktop and backsplash, complemented with a feature breakfast bar to complete the look.

Shown with:

Two Drawer Base Units

Mid Height Oven Housings (1590 High)

Matching Plinth

Brushed Steel Block Bar Handle Set (TH351 & TH354)

Bronze Glazed Wall Units with Brown Frame

Reference  see page 85









Shaker

in Shaker Woodgrain Light Grey
& Dust Grey
Five Piece Foil Woodgrain Shaker

The bevelled edge frame on this woodgrain door creates an interesting design twist to the traditional shaker door. Available in eight attractive finishes.

Shown with:

Feature Island with Hi-Line Base Units
Chrome Knob (TH1008) & Shell Handle (TH1009)





Shaker

in Shaker Bevelled Smooth Light Grey
Five Piece Foil Bevelled Smooth Shaker

This timeless design finished in a smooth matt painted effect gives a traditional feel to this popular classic style. Shown here with a perfectly chosen wooden worktop.

Shown with:

Feature Island with Two Drawer Base Units
(575 High)

Open Shelving in Natural Oak finish

Drawline Base Units

Matching Plinth & Panelling

Chrome Knob & Shell Handle Set
(TH1008 & TH1009)



Living area in matching front and worktop.

Shaker

in Shaker Bevelled Smooth Indigo Blue
Five Piece Foil Bevelled Smooth Shaker

An attractive shaker door in a smooth matt painted effect, combined with a mock in-frame design creates a traditional classic look.

Shown with:

Hi-Line Base Units
In-Frame look using universal moulding
Traditional Cornice
Matching Plinth & Panelling
Brushed Steel 9mm Square Bar Handle (TH1127)
Glazed Wall Units
Reference [CG](#) see page 85



Living area in matching front finish.





Shaker

in Shaker Bevelled Woodgrain Light Grey
Five Piece Foil Bevelled Woodgrain Shaker

Glazed dresser units add an attractive focus to this stylish bevelled edged woodgrain shaker door design.

Shown with:

Hi-Line Base Units
Three Drawer Base Units
Wall Units (575 High)
Traditional Cornice
Matching Plinth & Panelling
Chrome Knob & Shell Handle Set (TH1008 & TH1009)
Glazed Dresser Units
Reference [CG](#) see page 85



Feature Island Open Display Unit with plant on matching door panels.





Shaker

in Denim Blue
Chamfered Foil Shaker

A striking classic shaker kitchen with a modern twist utilising an on trend contemporary finish with complementary chrome handles.

Shown with:

Hi-line base units
Three drawer base units
Tall oven housing
Matching plinth & panelling
Chrome 9mm Square Bar Handle (TH1128)
& Chrome Shell Handle (TH1009)









Shaker

in Dust Grey
Mock Inframe Foil Shaker

A minimalist mock inframe shaker kitchen style which gives the illusion of an authentic timber inframe kitchen.

Shown with:

Pantry units

Drawline base units

Matching plinth and panelling

Stainless Steel Taper Bridge handle (TH302)
& Chrome Shell Handle (TH1009)

Shaker

in Painted Matt Shaker Light Grey
Painted Matt Shaker

This matt painted shaker style kitchen with wider frames and no feature joints is ideal for creating a clean and modern living space.

Shown with:

Two Drawer Base Units
Curved Base & Wall Units
Tall Oven Housing & Larder Units (2115 High)
Feature Island with Square Pilaster
Modern Cornice & Light Pelmet
Brushed Steel Case Bridge Handle (TH137)









Shaker

in Beaded Shaker Painted Light Grey &
Beaded Shaker Painted Dust Grey
Beaded Shaker Solid Painted

This stunning traditional kitchen with solid beaded doors offers iconic features that create a truly distinctive kitchen design for your home.

Shown with:

Hi-Line Base Units

Tall Larder Units (2115 High)

Traditional Cornice & Light Pelmet

Matching Plinth & Panelling

Chrome Knob Handle (TH1008)

Glazed Wall Units Reference [CB](#) see page 85

Shaker

in Painted Mussel Shaker &
Painted Sage Green Shaker
Solid Painted Shaker

A classic look has been created by using traditional features such as tongue and groove effect panelling and a feature canopy with a solid shaker painted door.

Shown with:

Feature Canopy

Feature Island with Square Pilasters

Wall Units (900 High)

Traditional Cornice & Light Pelmet

Matching Plinth & Tongue and Groove Panelling

Cast Iron 'D' Handle Set (TH490, TH1012 & TH1013)





Shaker

in Painted Pebble Grey Shaker &
Solid Light Oak Shaker
Solid Painted Shaker

This is the perfect classic shaker design that allows anyone to personalise their kitchen and make it their own. These solid doors in a woodgrain finish are available in a wide range of stunning colours.

Shown with:

Feature Island in Solid Light Oak with Open Display
& Four Drawer Base Units
Tall Larder Units with Over Cupboards
Traditional Cornice & Light Pelmet
Matching Plinth



Painted Ivory Shaker

Solid Painted Shaker. Shown with Chrome Shell Handle (TH1009) & Chrome Bow Handle (TH2006)



Shaker

in Painted Dust Grey Slim Shaker &
Painted Porcelain Slim Shaker
Solid Slim Painted Shaker

An elegant traditional kitchen can be created by combining a variety of colours. With 7 painted finishes available, this solid woodgrain slim frame shaker will suit almost any home.

Shown with:

Three Drawer Base Unit with Wide Top Drawer
Tall Oven Housing & Larder Units (2115 High)
Wall Units (720 High)
Traditional Cornice & Light Pelmet
Matching Plinth & Tongue & Groove Panelling
Chrome 9mm Square Bar Handle (TH1128)



Low level media furniture in matching front finish.





Handleless

in Handleless Light Grey Matt
Matt Painted Handleless

This stunning handleless kitchen in a painted matt finish creates a sleek minimalist look.

Shown with:

Hi-Line Base Units

End Panel with External Corner Profile Post

Matching Plinth

Smoked Glazed Wall Units with Black Frame

Reference  see page 85







Handleless

in Handleless Light Grey Gloss &
Handleless Dust Grey Gloss
Gloss Painted Handleless

A minimalist look can be created perfectly with a handleless design, available in matt or gloss.

Shown with:

Hi-Line Base Units
Tall Oven Housing & Larder Units (2115 High)
End Panels with External Corner Profile Post
Matching Plinth



Handleless Dust Grey Matt & Handleless Light Grey Matt
Matt Painted Handleless





Handleless

in Handleless Indigo Blue Matt
Matt Painted Handleless

These painted matt doors with a discreet integrated pull-handle create a stunning look with clean lines that are fresh and contemporary in design and style.

Shown with:

Hi-Line Base Units
Three Drawer Base Units with wide top drawer
Wall Units (720 High)
Tall Oven Housing & Larder Units (2115 High)
Matching Plinth & Panelling



Handleless

in Handleless Anthracite Gloss
Gloss Painted Handleless

These painted gloss doors in a handleless design create a stunning contemporary look. Shown here in a striking Anthracite gloss finish.

Shown with:

Hi-Line Base Units
Tall Oven Housing & Larder Units (2115 High)
Vertical Bi-Fold Wall Units (720 High)
Matching Plinth



Handleless White Gloss
Gloss Painted Handleless





Lighting solutions for your kitchen

Getting the lighting right in your kitchen is critical, it's the room that attracts the most use both day and night, so creating the mood that you desire can be done with careful planning. Please consider the choice of lighting options shown on the right, to create sufficient lighting for task, mood and convenience.





1. Over Cabinet & Plinth

LED flexible strip lighting added to the top or around the plinth enhancing the ambiance of the kitchen.

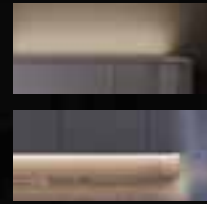

2. Under Cabinet Spot & Strip

Sufficient lighting is a must in task based areas where hobs, sinks and worktop surfaces are in use.



3. Drawer & In Cabinet

Lighting in cupboards and drawers adds the finishing touch to your kitchen.



4. Bluetooth Control

Bluetooth dimming and light temperature level control from your phone or tablet allowing many choices in lighting ambience.



5. Pop-up & Flip Over Point

This allows the user to plug in any appliance and charge any USB powered device within the convenience of the kitchen.



6. Colour Temperature

Most lighting is available in natural or warm white. In addition to these choices a range of tunable lights are available, allowing you to choose from cool to natural to warm white light to create your own lighting mood.



Clever storage



Everything in it's perfect place.

Everything within reach. **Easy to use and enjoy.**

Sometimes the simplest things are the most extraordinary.

Just as nature exhibits amazing efficiency among its elements, Kesseböhmer strives to achieve the perfect balance between form and function. And after 55 years, you can rest assured, they've figured it out. With clever storage that considers convenience for today's multi-use kitchens as much as it considers capacity. The elegance and functionality of the Cantilever Corner, Kesseböhmer turns ordinary cabinets into extraordinary kitchens. Truly innovative designs with non-slip surfaces, transparent storage and smooth handling that deliver a level of simplicity that is naturally easy to use and enjoy.

Tall Pull-Out Larder Unit

Although we can easily go out and fetch supplies practically whenever we like by popping to the nearest supermarket or even a petrol station (at night time or late on Sundays), every household still keeps a stock of foods. Pasta, sugar, flour, rice, salt, cocoa, jam, tinned food, sauces, ketchup ... are just a few examples.

Even this short list is enough to explain why it is that most people end up significantly underestimating the quantity and value of their own stored foods. One of the main reasons for this is that many kitchens do not have a specific, central place for stored foods. Instead, people nearly always store food in a wide range of cupboards. And that is anything other than ideal. You lose track of everything, you waste time searching for things and many foods are simply overlooked or forgotten. This leads to unnecessary duplicate purchases and is exactly the opposite of what you want. Now, at last, there is a solution with our tall Pull-Out Larder Unit!



150 Pull-Out

Good ideas fit in anywhere. Kesseböhmer creates much more than a tiny filler. When placed by the oven, the 150mm Pull-Out is the convenient solution for spices, baking trays or an indispensable towel. The high quality fitting lends even the smallest kitchen cabinets that special touch of elegance.

With Kesseböhmer - the worlds leading premium storage brand, our Kitchens include great design ideas not just on the outside but on the inside too.

Kesseböhmer storage solutions provide stylish, practical and functional solutions providing better organised and easier access to storage space. In addition to brilliant functionality, Kesseböhmer storage solutions stand for exclusive design and a high quality finish. Internal cabinet space is used more efficiently than conventional systems, helping you get the most out of your kitchen.



Cantilever Corner

Combines optimal space utilisation with a clear overview and ease of use. You can store a lot of pots and pans - and each one is always in easy reach.



Pull-Out Corner

Pull once gently and both the front pull-out and the rear one move forward into easy reach - all in one noiseless, flowing movement.



3/4 Carousel Corner

Quality Carousel Corner trays are offered in a contemporary silver grey finish with solid bases that provide for a stable non-slip storage solution.

The iMove

The intelligent pull-down system for wall units.

This pull down wall unit shelf system enables access to those difficult to reach areas. With an easy to operate pull down system which locks into an open position and then closes easily with one effortless movement. Transforming the classic wall unit in to an effective way of storing those everyday kitchen items.



Recycling Waste Bins

We have a selection of bins available to solve your recycling problems.

Our range of solutions makes recycling quicker and easier and what's more all of our bins are cleverly integrated within the kitchen!



Pull out waste bin units with recycling compartments available in 300, 400, 450, 500 & 600mm widths



Pull-Out Waste Bin



Swing Out Waste Bin

1 Select your door finish

Choosing your door style and finish is important. Colour match to your desired kitchen finish or choose a contrast to suit your personality.

PRICE GROUP 1 Matt MFC Slab



Lancaster Oak Slab Oak Dark Slab Springfield Light Oak Slab Natural Walnut Slab Nautic Oak Slab Anthracite Finline Slab Natural Oak Slab Sepia Gladstone Slab

PRICE GROUP 1 Matt Foil Slab

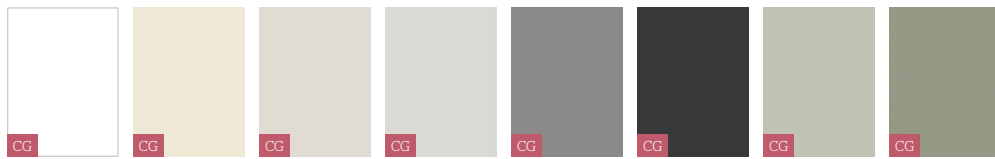

White Slab Mussel Slab Cashmere Slab Light Grey Slab Dust Grey Slab Charcoal Slab Meadow Green Slab Sage Slab



Kombu Green Slab Denim Blue Slab Indigo Blue Slab

PRICE GROUP 2 Matt Foil Plain Shaker

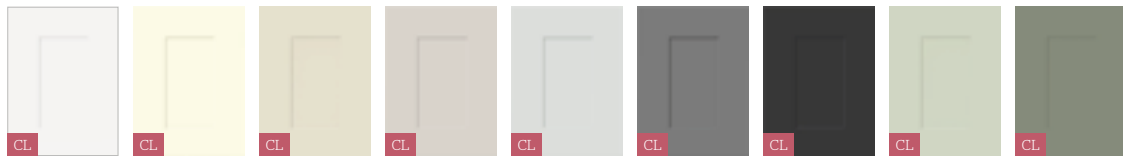

White Plain Shaker Ivory Plain Shaker Mussel Plain Shaker Cashmere Plain Shaker Light Grey Plain Shaker Dust Grey Plain Shaker Charcoal Plain Shaker Meadow Green Plain Shaker Sage Plain Shaker



Kombu Green Plain Shaker Denim Blue Plain Shaker Indigo Blue Plain Shaker

PRICE GROUP 2 Matt Foil Slim Shaker



White Slim Shaker Ivory Slim Shaker Mussel Slim Shaker Cashmere Slim Shaker Light Grey Slim Shaker Dust Grey Slim Shaker Charcoal Slim Shaker Meadow Green Slim Shaker Sage Slim Shaker



Kombu Green Slim Shaker Denim Blue Slim Shaker Indigo Blue Slim Shaker

GLAZED STYLES with the following symbols have a glazed door option.



PRICE GROUP 2 5 Piece Foil Woodgrain Shaker

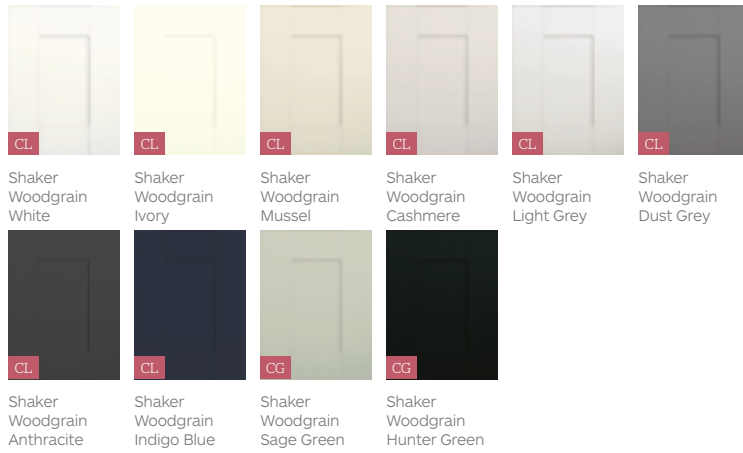

PRICE GROUP 2 5 Piece Foil Bevelled Woodgrain Shaker



PRICE GROUP 2 5 Piece Foil Bevelled Smooth Shaker



PRICE GROUP 2 Chamfered Foil Shaker

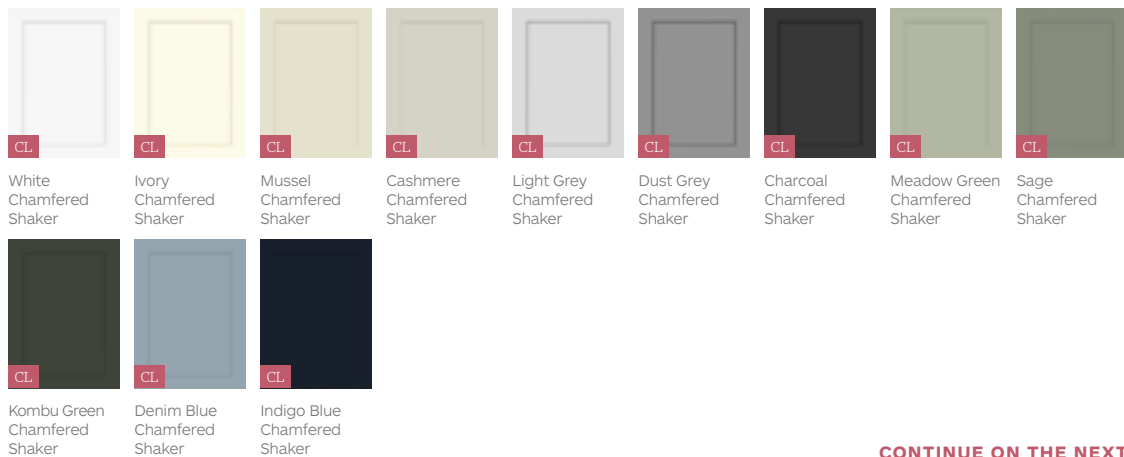

CONTINUE ON THE NEXT PAGE FOR MORE FINISHES

PRICE GROUP 2 Mock Inframe Foil Shaker

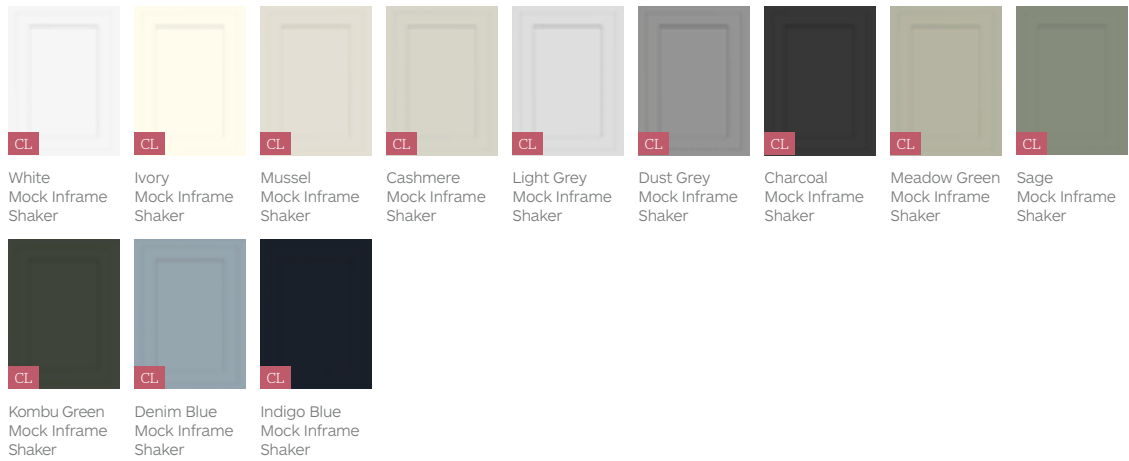

PRICE GROUP 2 Painted Matt Slab

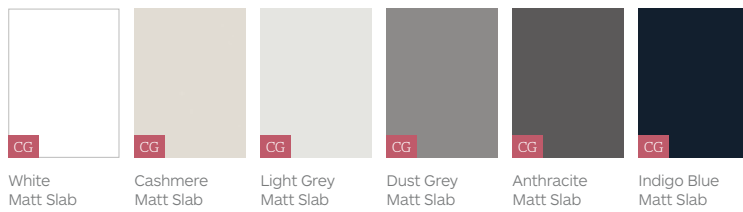

PRICE GROUP 2 Painted Gloss Slab



PRICE GROUP 2 Soft Matt Slab (Laminate Foil)

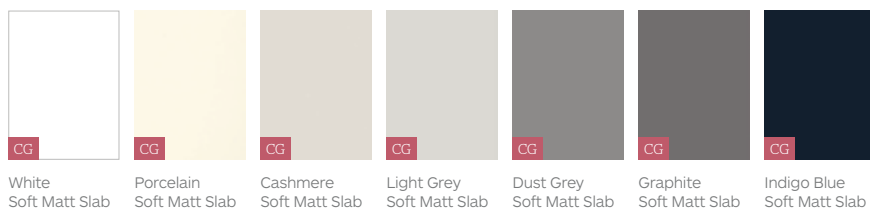

PRICE GROUP 3 Designer Matt MFC Slab



PRICE GROUP 4 Matt Painted Handleless

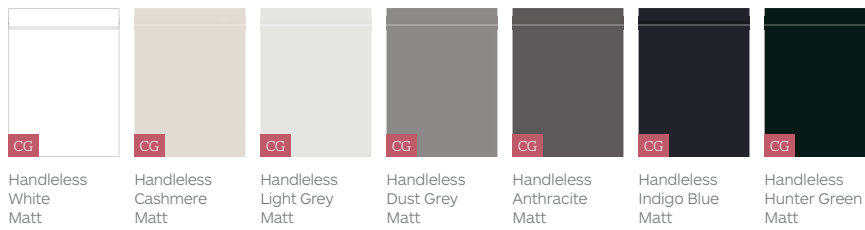

Handleless White Matt Handleless Cashmere Matt Handleless Light Grey Matt Handleless Dust Grey Matt Handleless Anthracite Matt Handleless Indigo Blue Matt Handleless Hunter Green Matt

PRICE GROUP 4 Gloss Painted Handleless



Handleless White Gloss Handleless Cashmere Gloss Handleless Light Grey Gloss Handleless Dust Grey Gloss Handleless Anthracite Gloss Handleless Indigo Blue Gloss

PRICE GROUP 4 Painted Matt Shaker

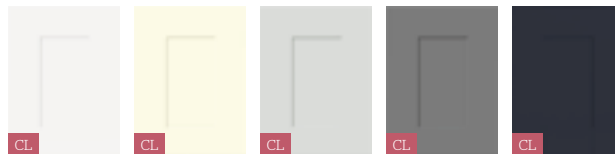

Painted Matt Shaker White Painted Matt Shaker Ivory Painted Matt Shaker Light Grey Painted Matt Shaker Dust Grey Painted Matt Shaker Indigo Blue

PRICE GROUP 5 Beaded Shaker Solid Painted

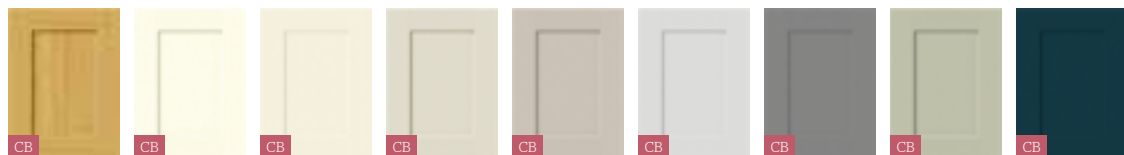

Beaded Shaker Solid Light Oak Beaded Shaker Painted Ivory Beaded Shaker Painted Porcelain Beaded Shaker Painted Mussel Beaded Shaker Painted Pebble Grey Beaded Shaker Painted Light Grey Beaded Shaker Painted Dust Grey Beaded Shaker Painted Sage Green Beaded Shaker Painted Marine

PRICE GROUP 5 Solid Painted Shaker



Solid Light Oak Shaker Painted Ivory Shaker Painted Porcelain Shaker Painted Mussel Shaker Painted Pebble Grey Shaker Painted Light Grey Shaker Painted Dust Grey Shaker Painted Sage Green Shaker Painted Marine Shaker

PRICE GROUP 5 Solid Slim Painted Shaker



Painted Ivory Slim Shaker Painted Porcelain Slim Shaker Painted Mussel Slim Shaker Painted Pebble Grey Slim Shaker Painted Light Grey Slim Shaker Painted Dust Grey Slim Shaker Painted Marine Slim Shaker

2 Choose your cabinet finish

Choose from a selection of 20 cabinet finishes to co-ordinate with your chosen door finish or alternatively choose your own look by using a contrasting colour. They look as good on the inside as they do on the outside.

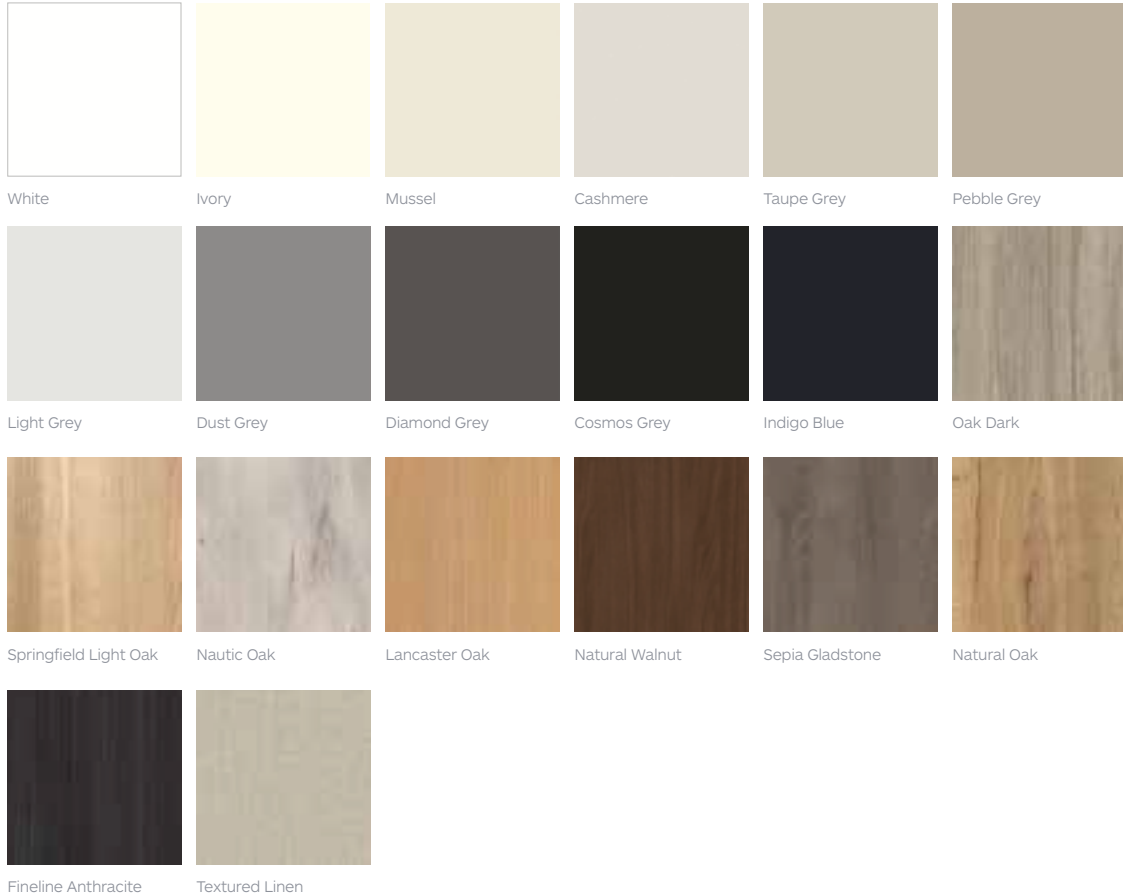

3 Choose your worktop finish

With 40 traditional and contemporary finishes, ranging from a slim 16mm squared edged worktop through to a 38mm radiused style, you are guaranteed to find the perfect match for your dream kitchen.

16MM SQUARE EDGE

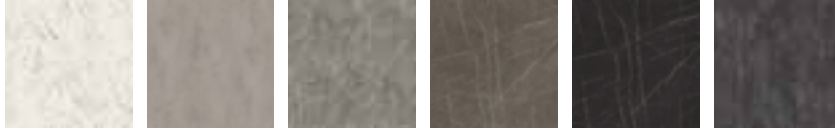

White Carrara Marble Chromix Silver Light Grey Metal Rock Anthracite Pietra Grigia Black Pietra Grigia Silver Grey Metal Slate

25MM SQUARE EDGE



White Levanto Marble White Chromix Grey Braganza Granite Grey Sienna Marble Anthracite Metal Rock Black Gold Metal Slate

38MM SQUARE EDGE



Sand Grey Glazed Halifax Oak White Halifax Oak Natural Halifax Oak Pewter Halifax Oak

38MM POSTFORMED



Premium White Oak Butcherblock Walnut Butcherblock Cascina Pine Pasedena Pine Grey Brown Whiteriver Oak Grey Bardolino Oak Natural Hamilton Oak



Dark Hunton Oak White Carrara Marble Light Grey Valmasino Marble Light Grey Chicago Concrete Travertine Tavolo Taupe Light Cefalu Concrete Light Grey Metal Rock Bronze Chromix



Anthracite Pietra Grigia Black Pietra Grigia Chromix Silver Silver Grey Metal Slate Anthracite Jura Slate White Sparkle Grain Grey Sparkle Grain Black Sparkle Grain

4 Choose your handle

Choose from our selection handles to complete your perfect kitchen.

Brushed Brass Knob



TH1141

Antique Pewter Knob



TH350

Brushed Nickel Oval Knob



TH2007

Antique Oval Knob



TH2008

Antique Copper Knob



TH1131

Oak Knob



TH570

American Copper Knob



TH1164

Brushed Nickel Knob



TH1165

Brushed Copper 9mm Square Bar Handle



TH1063

Black Steel 9mm Square Bar Handle



TH1125

Grey 9mm Square Bar Handle



TH1126

Brushed Steel 9mm Square Bar Handle



TH1127

Chrome 9mm Square Bar Handle



TH1128

Antique Brass 9mm Square Bar Handle



TH1129

Stainless Steel Taper Bridge Handle



TH302

Modern Chrome 'D' Handle



TH112

Brushed Steel Bow Bridge Handle



TH358

Brushed Steel Case Bridge Handle



TH137

Chrome Bow Handle



TH2006

Aluminium Bow Handle



TH359

Satin Nickel Bow Handle



TH2005

Antique Copper 'D' Handle



TH1132

Modern Chrome 'D' Trim Handle

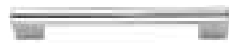

TH305

Cast Iron 'D' Handle Set



TH490



TH1012



TH1013

Chrome Knob & Shell Handle Set



TH1008



TH1009

Antique Bronze Knob & Shell Handle Set



TH1041



TH1040

Copper Knob



TH1149

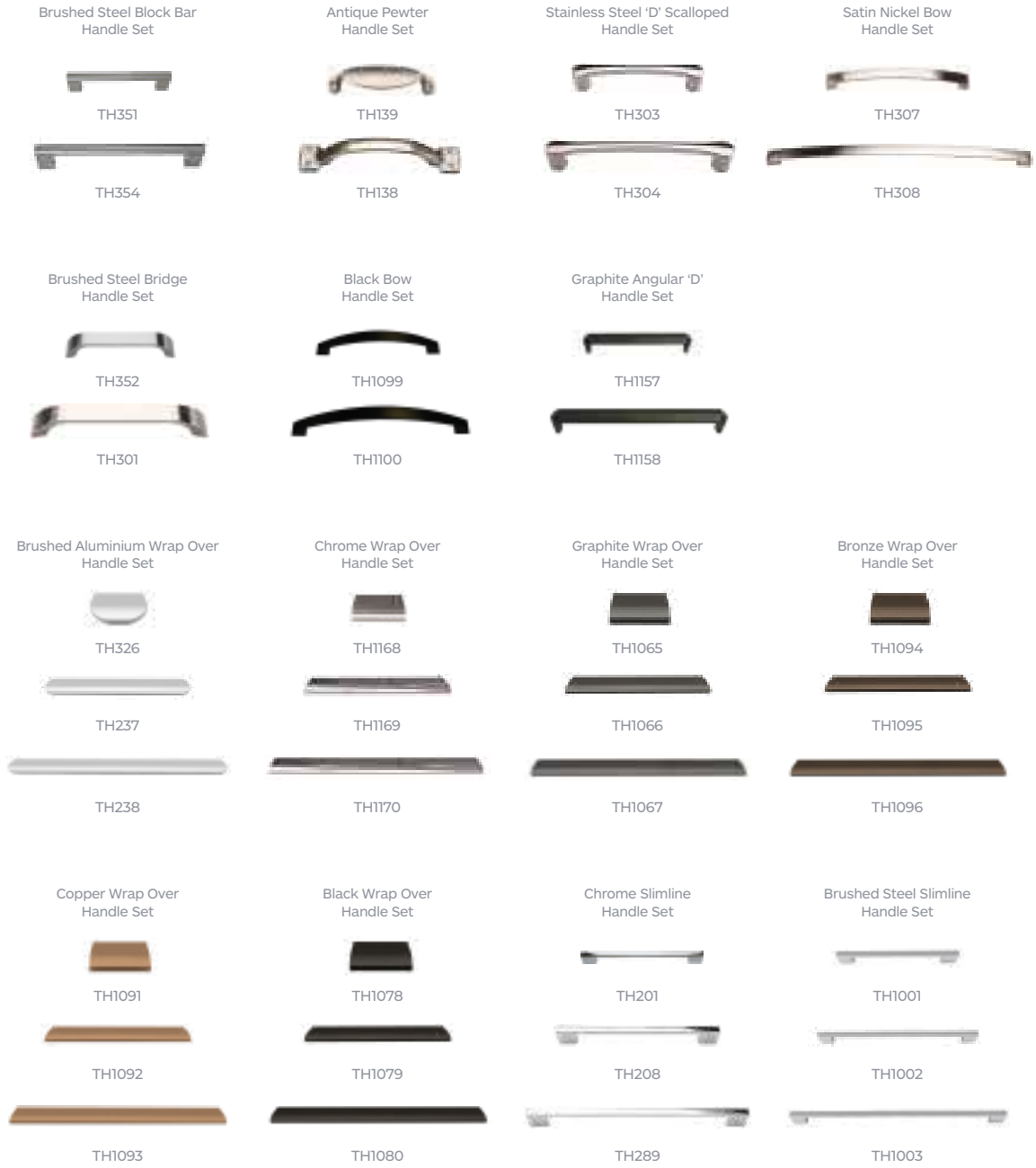

Stainless Steel Boss Bar Handle
(Set of 5 sizes available)



14mm Bar depth



Alusplash Backsplash

AluSplash is an aluminium kitchen splashback which is fire resistant, grout free and easy to clean and maintain. It is the ideal interior wall panel, as it gives a modern finish to any kitchen space.

Safe, Hygienic & Low Maintenance

- Grout free and non-porous
- Dirt and grime can be easily wiped and cleaned with a microfiber cloth
- Non-toxic and Lead-free paint surface
- Will not shatter or crack like glass
- Easy to clean and maintain

Eco Friendly

- 100% post-consumer recyclable
- Non-toxic and Lead-free
- No emissions of greenhouse gases during production

Fire Resistant

- Fire rated and safe to use behind gas hobs, unlike acrylic splashbacks
- Suitable to be used behind all popular hobs
- Maintain a 30mm / 1.18" distance from the edge of the hob

Quick & Easy to Install

- Does not require expensive professional installation
- Fabricate with normal wood working tools
- Can be installed 3 times faster than tile splashbacks
- Can be V-grooved & folded around the corners, without joints
- Easy to make cut outs for electrical sockets
- Full range of edge and corner profiles available for a clean finish

	AluSplash	Glass	Acrylic	Tiles	Painted Walls
Easy Maintenance	✓	✓	✓	✗	✗
Fire Resistant	✓	✓	✗	✓	✓
DIY & Easy Fabrication	✓	✗	✓	✗	✓
Quick Installation	✓	✗	✓	✗	✓
Affordability	✓	✗	✓	✓	✓
Durability	✓	✗	✓	✓	✗
Formability	✓	✗	✓	✗	✗
Can be V-grooved & folded around the corners	✓	✗	✗	✗	✗

16MM SQUARE EDGE



Ice White (Polished)

Ocean Wave (Polished)

Silver Brushed (Polished)

Space Silver (Polished)

Latte Metallic (Polished)



Warm Grey Metallic (Polished)

Olive Green (Polished)

Totally Teal (Polished)

Blueberry Metallic (Polished)

Petrol Blue Metallic (Polished)



Metallic Black (Polished)

Juicy Red (Polished)

16MM SQUARE EDGE



Iceberg White (Textured)

Lava Stone (Textured)

Green Mist (Textured)

Smoked Ember (Textured)

Midnight Moon (Textured)



Frosted Flora (Textured)

Forest Green (Textured)

Autumn Leaves (Textured)

White Cararra (Smooth Matt)

Essential Planning Information

Planning Your Space

The kitchen is the heart of every home, now used for so much more than just cooking. When you are ready to begin planning look carefully at the available space. What shape is the room and how can you get the most out of it, taking into account all the requirements of your busy lifestyle.

Layout Considerations

Consider how you use your kitchen and what you like about it. Think about what you would change from increasing storage space to ensuring you have enough preparation area. Make a list of the things you'd like to keep and what you'd like to change. This will be useful when planning your space.

Working Zones

Most kitchens work best divided into work zones covering storage (fridge/freezer/larder), washing (sink/dishwasher) and cooking (oven/hob).

The relationship between these three zones are often referred to as 'the working triangle' and if positioned correctly will ensure a practical and efficient layout making the kitchen a joy to use.

Straight



'L' Shape



Galley

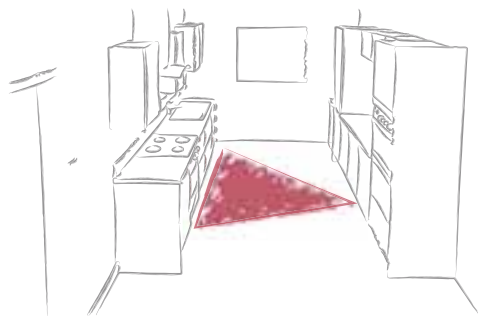

'U' Shape



Measuring your space

Successful kitchen planning starts with accurate and precise measurements. Careful preparation at this stage will ensure a smooth process leading to a kitchen that will fit perfectly.

1. Start by measuring the overall length of all walls and the height from floor to ceiling and record these in millimetres on your plan.
2. Measure each window and door by detailing the floor to sill, the height and width and the distance from the ceiling and room corners remembering to include the frame.
3. Check for obstructions such as radiators, meters, extractors or ventilation grilles and detail these on the plan.
4. Note the position of any stop taps, water and gas pipes and outside drain that the waste pipe runs into.
5. Finally mark any existing power points and light switches on your plan.

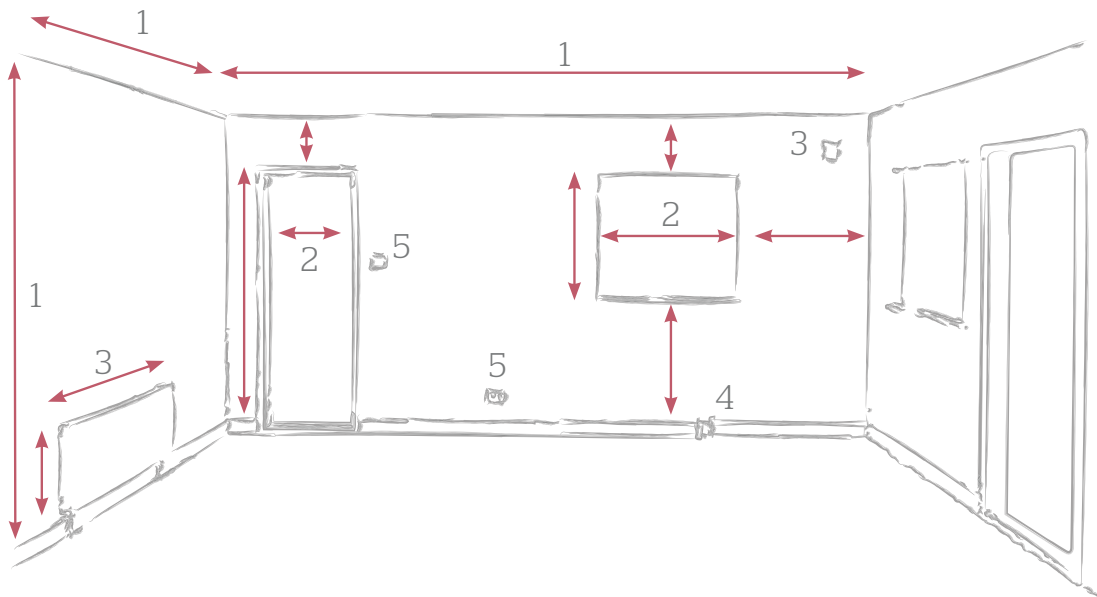





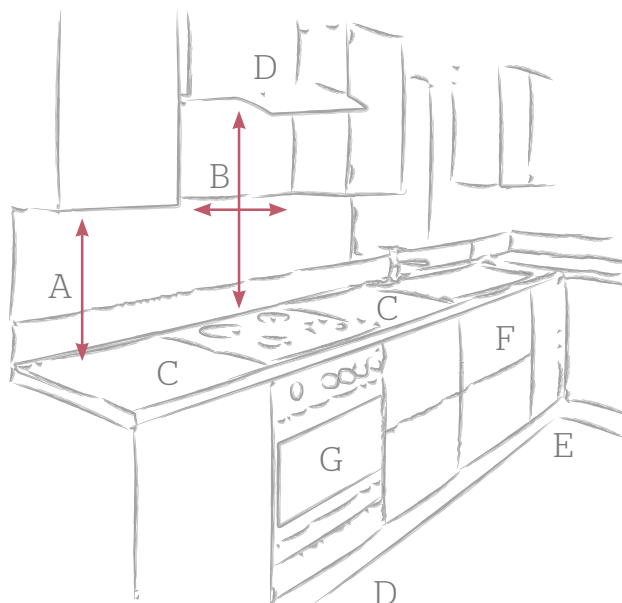



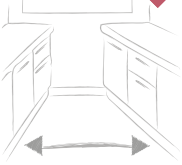

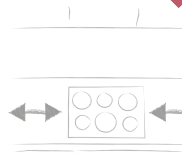
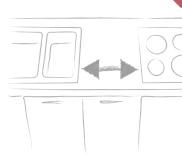
Further tips

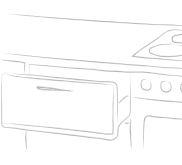
- A. Splashback height
- B. Hob clearances
- C. Preparation spaces
- D. Oven ventilation
- E. Corner planning
- F. Drawer options
- G. Appliances



Design points to consider

 <p>Allow sufficient space to pass comfortably between units remembering to allow for doors and drawers to open fully.</p>	 <p>Small fillers should be planned between all walls and units allowing for uneven walls and clearance for door opening.</p>	 <p>Think about providing space to place hot pans onto a pan stand close to the hob.</p>	 <p>Plan sufficient worktop space for preparation especially in the hob and sink area.</p>
 <p>Place on an outside wall if possible and ensure manufacturers recommended extractor / hob clearances are maintained.</p>	 <p>Consider the appliances you have and any additional ones you would like to include.</p>	 <p>Think about drawer and pan drawer storage requirements and their location for ease of access.</p>	 <p>Dishwashers should be as close to the sink as possible for ease of use and plumbing.</p>
 <p>If possible avoid placing drawer units in corner situations.</p>	 <p>It is not recommended to plan ovens adjacent to walls.</p>	 <p>It is not recommended to plan sinks adjacent to walls.</p>	 <p>It is not recommended to plan ovens in corner situations.</p>

Finishing touches

Once you are happy with the overall layout consider including some additional design features such as glazed wall units or lighting to complete your kitchen.

Collect ideas for colour schemes from magazines and the internet. Make a lifestyle board to compare colours and finishes for walls, flooring and fabrics. This will help with your design.

Cabinet features

- 1 Traditional Glue and dowel construction supplied fully assembled.
- 2 Rigid 19mm MFC Cabinets in 20 colour options with 8mm matching backs.
- 3 Handed cabinet units without unsightly drillings.
- 4 Solid top shelf on base units, sink & hob units supplied with rail for access.
- 5 Robust Thermoplast ABS edging to all exposed edges.
- 6 All cabinets have built in soft closing systems fitted to doors, drawers and mechanisms.
- 7 500 deep grey steel drawers complete with steel backs, supplied with soft closing and full extension runners. Pan drawers are fitted with 201mm high backs and square gallery side rails.
- 8 30Kg standard steel drawer capacity. 50Kg on 800/900/1000 widths.
- 9 Quality internal wirework fittings in a silver grey finish with soft close mechanisms.
- 10 All metal 110° 3 way fully adjustable clip on hinges for easy adjustment and removal if required.
- 11 Fully adjustable concealed wall cabinet hanging brackets provide a secure and neat finish.
- 12 Adjustable middle shelves edged all round with Stainless steel shelf support pegs.



- 13 Fitted integrated door buffers on all door and drawer fronts.
- 14 150mm adjustable legs with 5th leg on double cabinets.
- 15 Base & Tall cabinet service void gap of 47mm, Wall cabinet void of 17mm.

Optional Features

- Wooden oak dovetail drawer box and pan drawer options.
- Aluminium sink drip trays.
- Extensive choice of handle styles & finishes.
- Additional middle shelf for Hi-line base units.
- Non-slip drawer insert mats.
- Plinth sealing strip floor profile.

All cabinets are made to order & hand built in the UK.



Profile



Slab



Shaker



Handleless

